

1540 ~ MILL ST ~ RANCHO AVE. TO EUCALYPTUS AVE. ~ GRADING PLAN ~


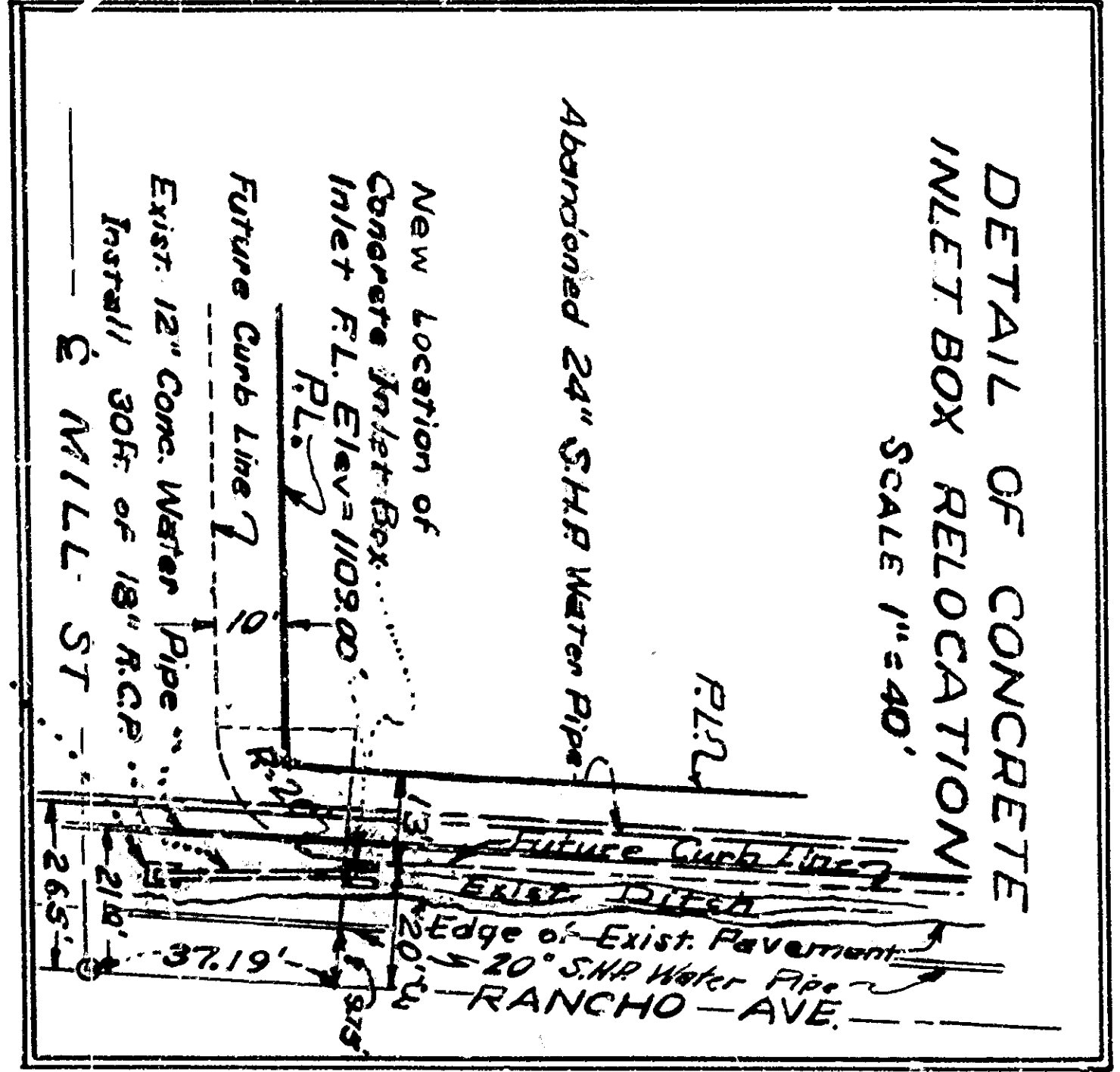
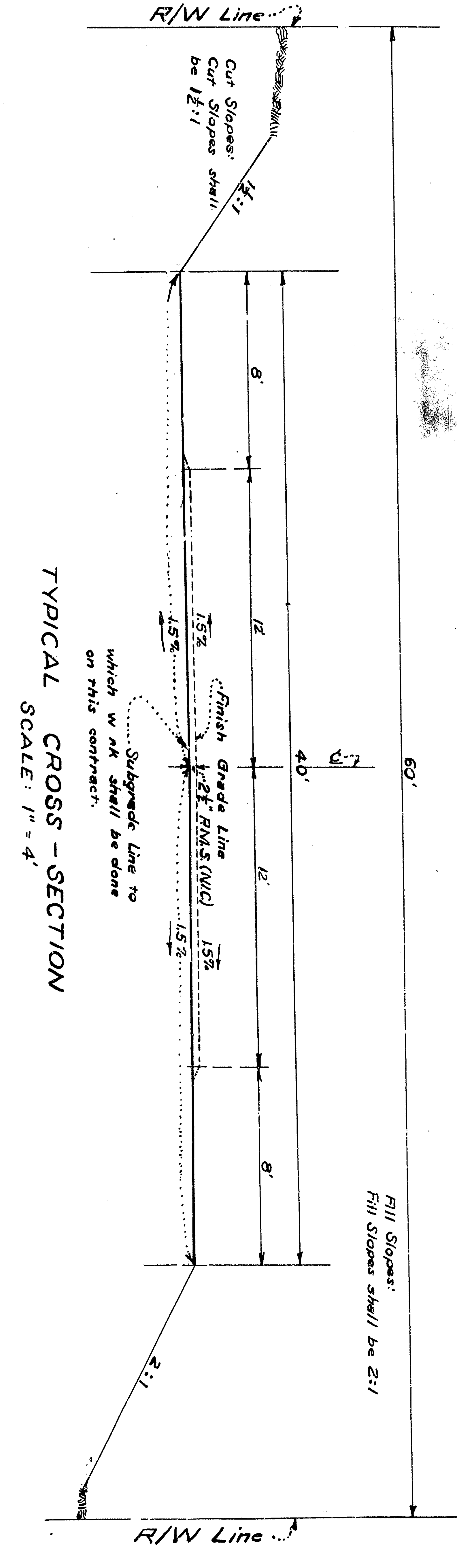


**NOTE:**  
At Sta. 18+80.3, grade existing dirt road for a distance of 100 ft. North and 100 ft. South of E. to meet existing ground. Mill St. for the first 50 ft. will be during construction.

**Notes:**  
\* To be removed under this contract.  
N.C. = Not in Contract.  
R & R = Remove and Rebuild under this contract as directed by the Engineer.  
To this elevation shown herein add 0.70' to obtain M.S.L. Datum

Sub. List of Job Change Description  
A. Move drainage structure from Sta. 0+00 to Sta. 14+53  
- Change structure from 36" to 48"  
- Change structure from 12" RCP to 18" RCP  
At Sta. 12+00 Change 12" RCP to 18" RCP

**MILL ST. RANCHO AVE. TO EUCALYPTUS AVE. GRADING PLAN**

NO.	DATE	REVISION
1		ISSUED FOR BIDDING
2		ISSUED FOR BIDDING
3		ISSUED FOR BIDDING

APPROVED: *[Signature]* DATE: Aug. 9, 1954  
CHECKED: *[Signature]* DATE:   
CITY OF *[Signature]*  
SCALE: 1" = 80'